

J1, J2 CONNECTOR

TERMINAL BLOCK PLUGS

COVER SCREWS INCLUDED

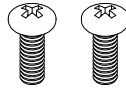
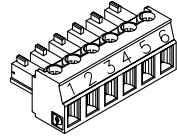
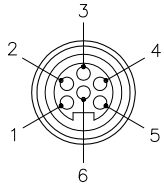

FORM 8 CONDUIT BODIES:  
10-24 SCREWS

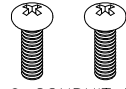

MARK 9 CONDUIT BODIES:  
8-32 SCREWS

SPECIFICATIONS

HOUSING MATERIAL/COLOR	NYLON 66 - 33% GLASS FILLED/BLACK
RECEPTACLE HOUSING/PLATING	316 STAINLESS STEEL/PASSIVATED
CONTACT CARRIERS/COLOR	TPU/BLACK
CONTACTS	BRASS/GOLD
OPERATING VOLTAGE	250 V
OPERATING CURRENT	8.0 A PER CONDUCTOR
PROTECTION CLASS to DIN 40050	IP 67 - ONLY WHEN ALL RECEPTACLES ARE COVERED WITH PLUGS OR CONNECTED
OPERATING TEMPERATURE	-30°C to +80°C (-22°F to +176°F)

WIRING DIAGRAM

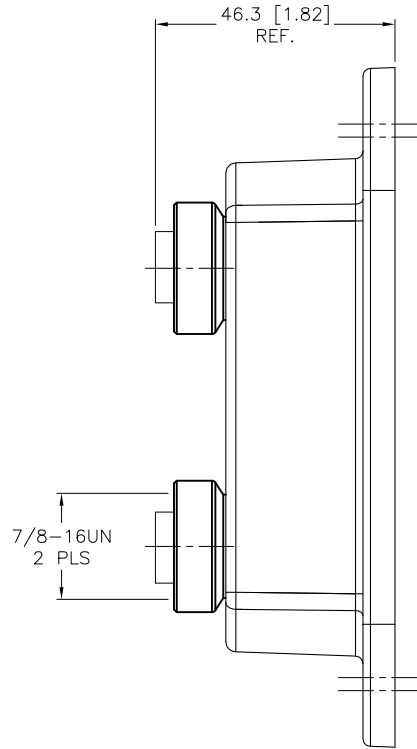
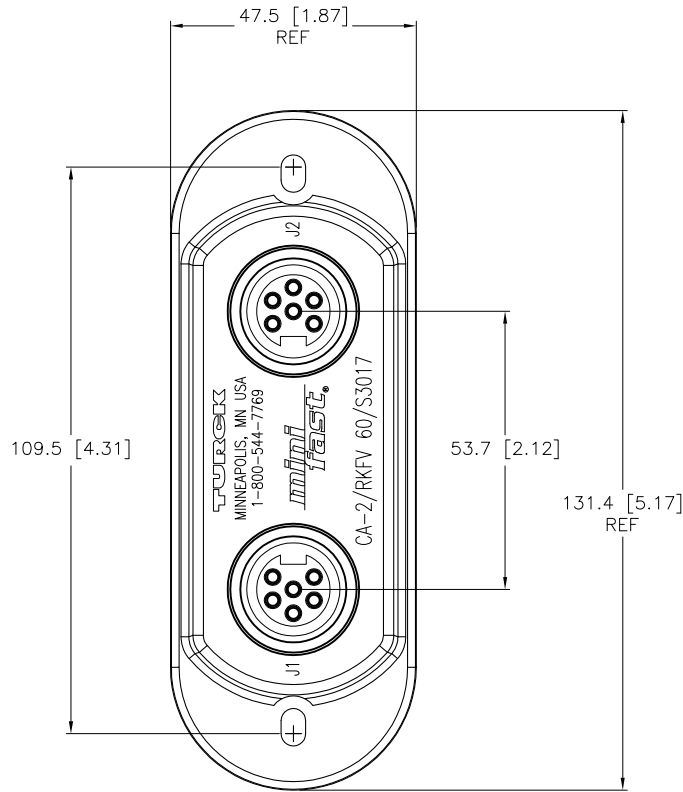
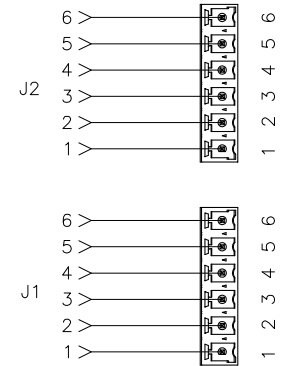

SEALING GASKET

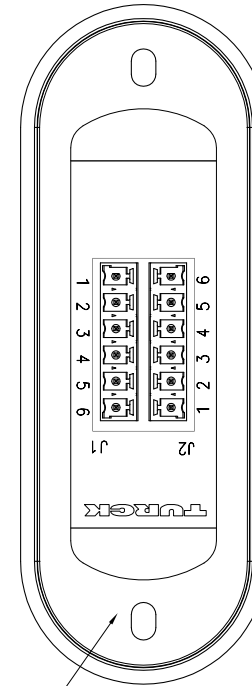

SOURCE DRAWING - FOR REFERENCE ONLY

RELATED DOCUMENTS		3RD ANGLE PROJECTION		THIS DRAWING IS PROPERTY OF TURCK INC. USE OF THIS DOCUMENT WITHOUT WRITTEN PERMISSION IS PROHIBITED.		<b>TURCK INC</b> High Technology Sensors and Automation Controls 3000 CAMPUS DRIVE MINNEAPOLIS, MN 55441 1-800-544-7769 (763) 553-7300 (763) 553-0708 fax turck.com	
1. 2. 3. 4.				DRFT MJM	DATE 12/19/06	DESCRIPTION CA-2/RKFV 60/S3017	
MATERIAL SEE SPECIFICATIONS		ALL DIMENSIONS DISPLAYED ON THIS DRAWING ARE FOR REFERENCE ONLY		DSGN	SCALE 1=1.5	IDENTIFICATION NO. U2-10080	
FINISH SEE SPECIFICATIONS		CONTACT TURCK FOR MORE INFORMATION		UNIT OF MEASUREMENT <b>MILLIMETER [ INCH ]</b>		REV B	
B DRAWING PROCESSED AS PART OF ECO 33971		CBM 04/07/11 33971		DO NOT SCALE THIS DRAWING		FILE: U2-10080	
REV DESCRIPTION		BY DATE ECO NO.		SHEET 1 OF 1			

